



# Passion creates the show

HMI® - true expressions revealed

Create scenes that bring intensity to every expression. True HMI® lighting creates daylight with pure color and amazing brightness. Let the magical moments of a great production be revealed.

[osram.us/HMI](http://osram.us/HMI)

55+ YEARS  
HMI

amun OSRAM

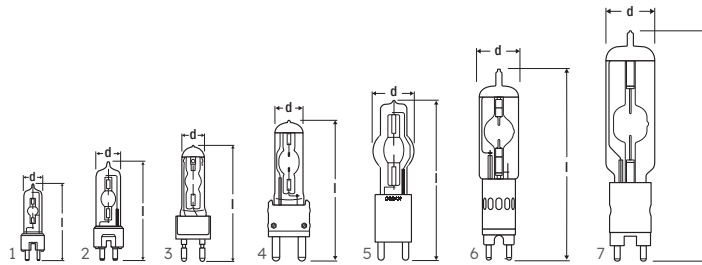

## HMI® DIGITAL

Lamp Description	Product Number	Watts	Volts	Current (Amps)	Base	Lumens	Avg Rated Life (hrs)	Color Temp (K) <sup>1</sup>	Diameter (d) (mm)	Length (l) (mm)	Operating Position	Line Drawing No.
HMI® DIGITAL 200W	55072	200	69	2.9	GZY9.5	16000	200	6900	20	80	Any	1
HMI® DIGITAL 400W	55073	400	75	5.3	GZY9.5	32500	650	6700	23	110	Any	2
HMI® DIGITAL 575W	55074	575	94	6.1	G22	49000	1000	6400	30	145	Any	3
HMI® DIGITAL 800W	55076	800	95	8.4	G22	69000	1000	6300	30	145	Any	3
HMI® DIGITAL 1200W	55077	1200	100	12	G38	110000	1000	6800	40	200	Any	4
HMI® DIGITAL 1600W	56782	1600	155	10.3	G22	144000	750	7250	42	173	Any	3
HMI® DIGITAL 1800W	55078	1800	140	13	G38	165000	750	6500	40	210	Any	4
HMI® DIGITAL 2500W	55182	2500	118	24.5	G38	220000	500	6300	60	220	Any	5
HMI® DIGITAL 4000W	55081	4000	195	24.5	G38	387000	500	5850	75	260	s135	5
HMI® DIGITAL 6000W	59584	6000	121	50	GX38	600000	500	6000	74	360	s135	6
HMI® DIGITAL 9000W	59941	9000	165	55	GX38	875000	400	6000	80	380	s135	6
HMI® DIGITAL 18000W	59585	18000	232	78	GX51	1600000	350	6000	100	495	s135	7

## HMI® single-end (other)

HMI® 2500W/SE/XS	54070	2500	115	25.6	G38	220000	500	6000	60	225	Any	5
HMI® 4000W/SE/XS	54321	4000	200	24	G38	380000	500	6000	75	250	s135	5
HMI® 12000W/SE/XS	54113	12000	160	84	GX38	1150000	500	6000	100	450	s135	6
HMI® 18000W/SE GX51	54324	18000	225	88	GX51	1600000	350	6000	100	495	s135	7

<sup>1</sup> Designed to approximate daylight color temperature (5600K to 6200K) inside of a fixture. Color temperature will vary based on the ballast used and its operating frequency.

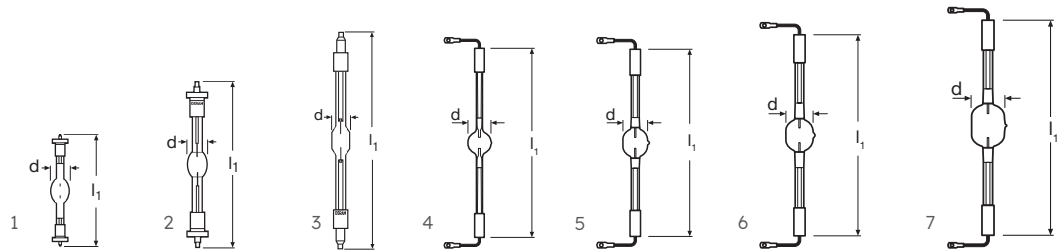

## HMI® double-end

Lamp Description	Product Number	Watts	Volts	Current (Amps)	Base	Lumens	Avg Rated Life (hrs)	Color Temp (K)	Diameter (d) (mm)	Length (l) (mm)	Operating Position	Line Drawing No.
HMI® 575W/DXS	54313	575	95	7	SFc10-4	49000	1000	6000	21	135	Any	1
HMI® 1200W/DXS	55139	1200	100	13.8	SFc15.5	110000	1000	6000	27	220	Any	2
HMI® 2500W/S XS	54068	2500	115	25.6	SFa21-12	240000	500	6000	31.5	210	p30	3
HMI® 2500W/DXS	54265	2500	115	25.6	SFa21	240000	500	6000	31.5	355	p30	3
HMI® 4000W/DXS	54314	4000	200	24	SFa21	380000	500	6000	36	405	p15	3
HMI® 6000W/DXS	54315	6000	123	55	S25.5	570000	500	6000	54	450	p15	4
HMI® 12000W/DXS	54316	12000	160	84	S30	1150000	500	6000	64	470	p15	5
HMI® 18000W/DXS	54213	18000	225	86	S30	1700000	500	6000	70	500	p15	6
HMI® 24000W/DXS	54325	24000	280	88	S30	2300000	500	6000	83	500	p15	7

ams OSRAM Group  
ams-osram.com

OSRAM SYLVANIA Inc.

Entertainment & Industry:

129 Portsmouth Avenue

Exeter, NH 03833 USA

US & Canada: 888-677-2627

Mexico: +52 55 1000 0200

osram.us/entertainment-industry

OSRAM and HMI are registered trademarks of OSRAM GmbH. OSRAM does not accept liability for errors, changes and omissions. All other trademarks are those of their respective owners. Specifications subject to change without notice.

© 2022 OSRAM SYLVANIA Inc.

